

(Y) Customer's housing must be  $\varnothing 565 \text{ H8}$  (E)  
Customer housing for (Y) and shaft for (X) must be concentric at 0.3

Rotor shoulder position on cable side

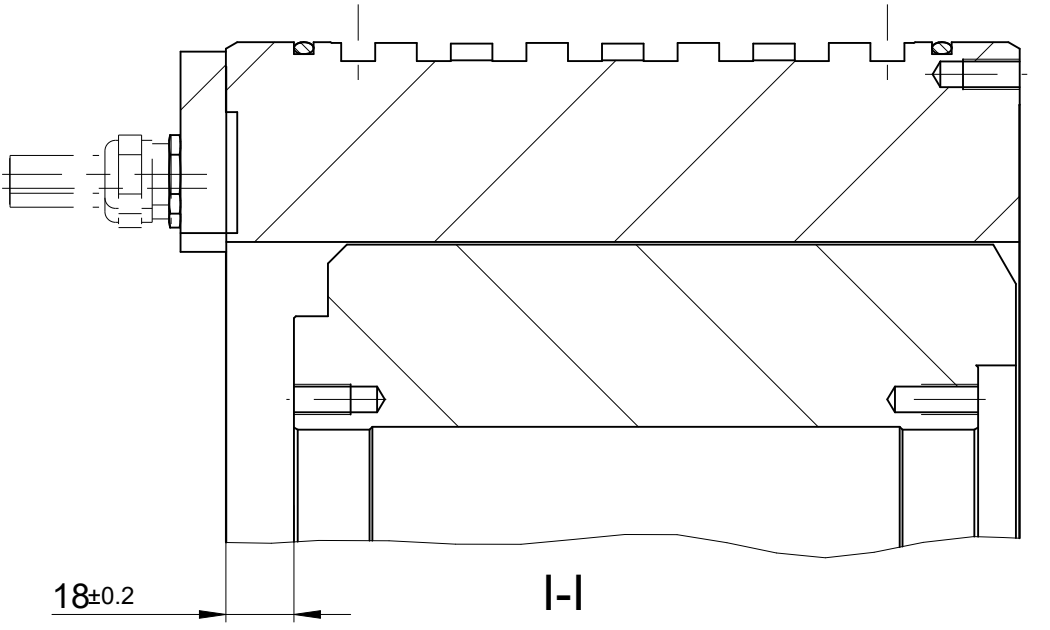

Rotor shoulder position on opposite side of cable

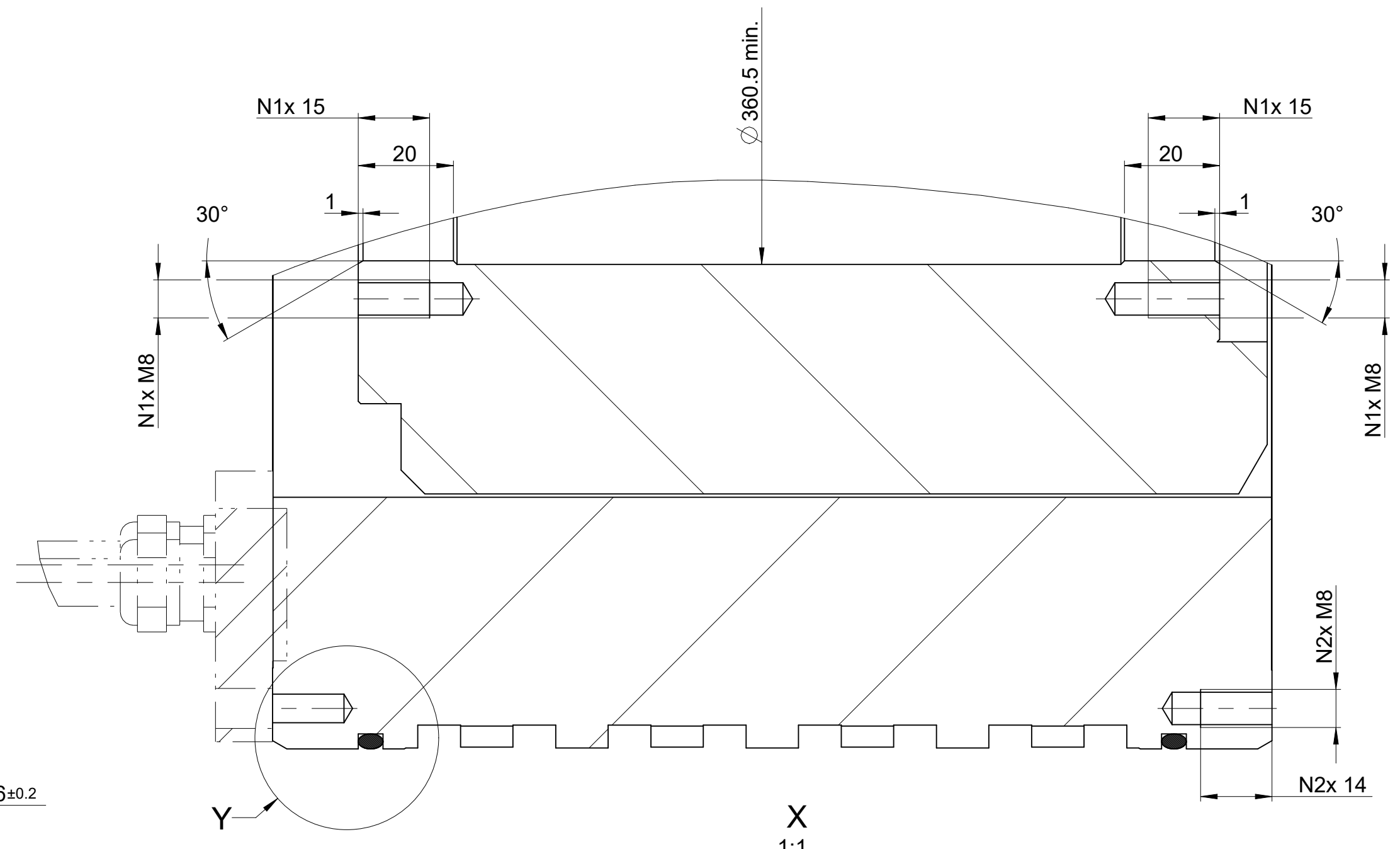
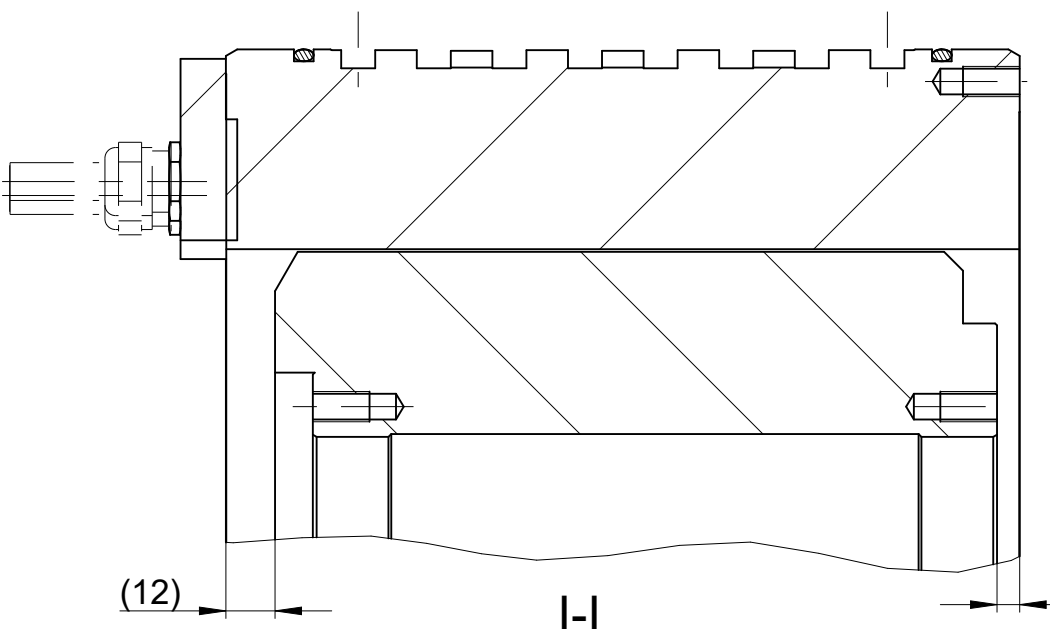

Y Same dimensions on the right side  
4:1

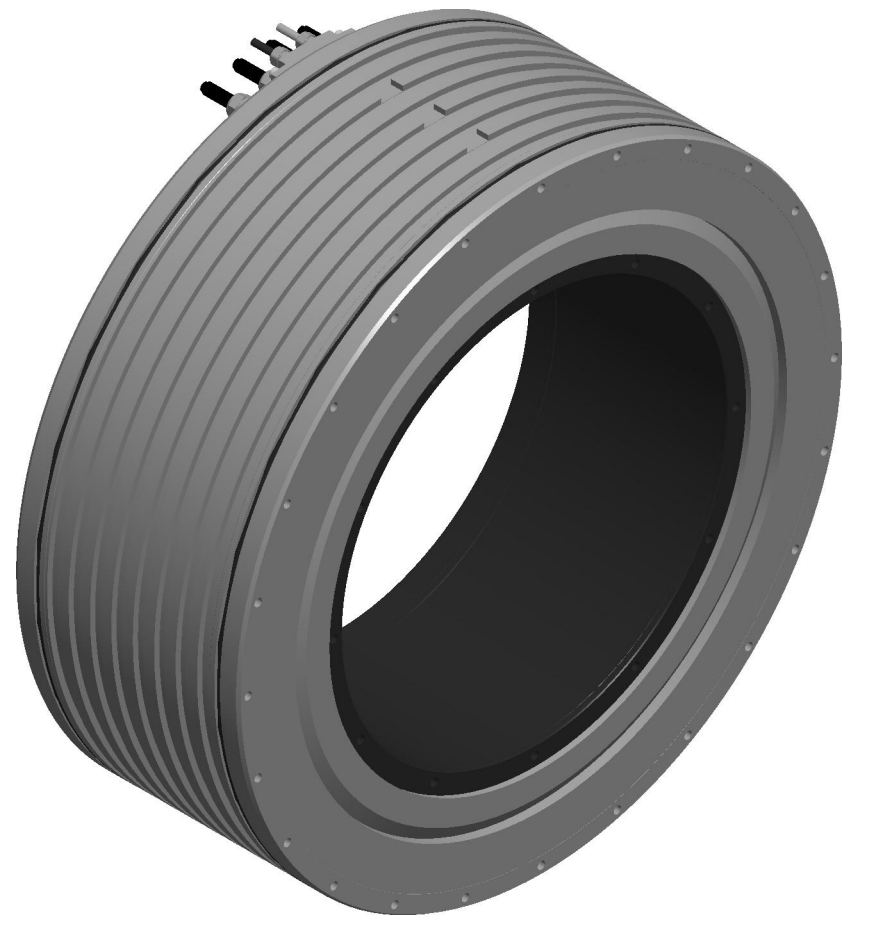
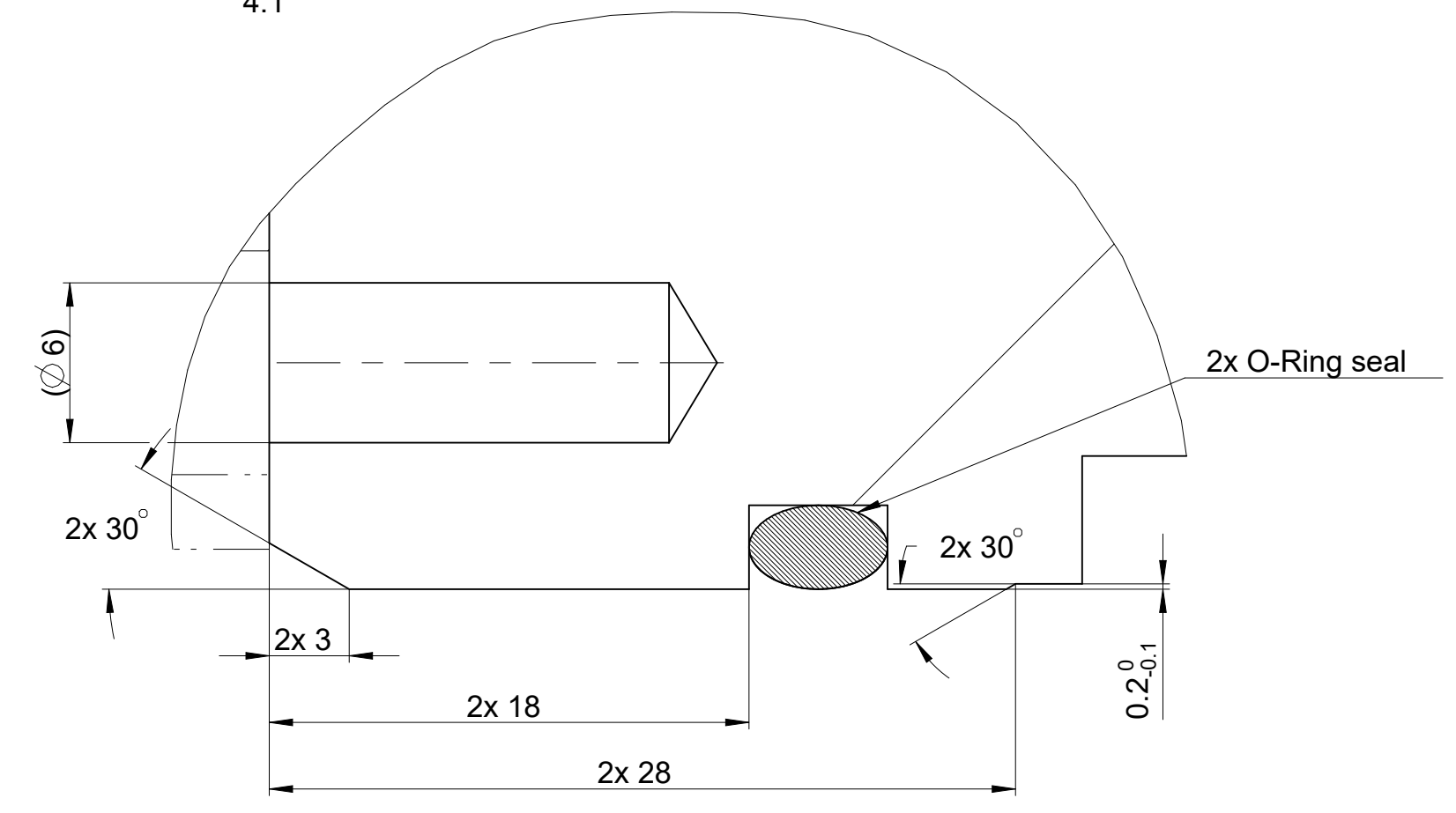

⚠ Use M8 screws with 12.9 quality to assemble rotor and stator

PRODUCT	L1	L2	L3	N1	N2	N3	β
TMK-0530-050	110	81	40	12	12	5	30°
TMK-0530-070	130	101	60	12	12	5	30°
TMK-0530-100	160	131	90	24	24	10	15°
TMK-0530-150	210	181	140	24	24	10	15°

Text:		ID number	
Original drawing	Scale	Format	Change No. C115144-04
RoHS	1:1	A1	Released: 18.09.2020
Dimensions in mm / Cotes en mm		Mating Dimensions / Cotes d'encombrement	
Workpiece edges ISO 13715		General tolerances ISO 2768-mK	
Arêtes de formes selon ISO 13715		Tolérances générales ISO 2768-mK	
-0.1 L±0.3		+0.3 L±0.0	
Tolerances as per ISO 8015: 2011		Tolérances selon ISO 8015: 2011	
Surfaces as per ISO 1302		Etats de surface selon ISO 1302	
Surface treatment:		Traitement de surface:	
The reproduction, distribution and utilization of this document as well as the communication of its contents to others without express authorization is prohibited. Offenders will be held liable for the payment of damages. All rights reserved in the event of the grant of a patent, utility model or design. (ISO 15015)			
<b>ETEL</b> ETEL S.A. 2112 Möhlers SWITZERLAND		Version/Revision/Sheet Page 677923-05-A-01 1 of 1	

TMK0530-3UDN-U## and 3SDN-U##

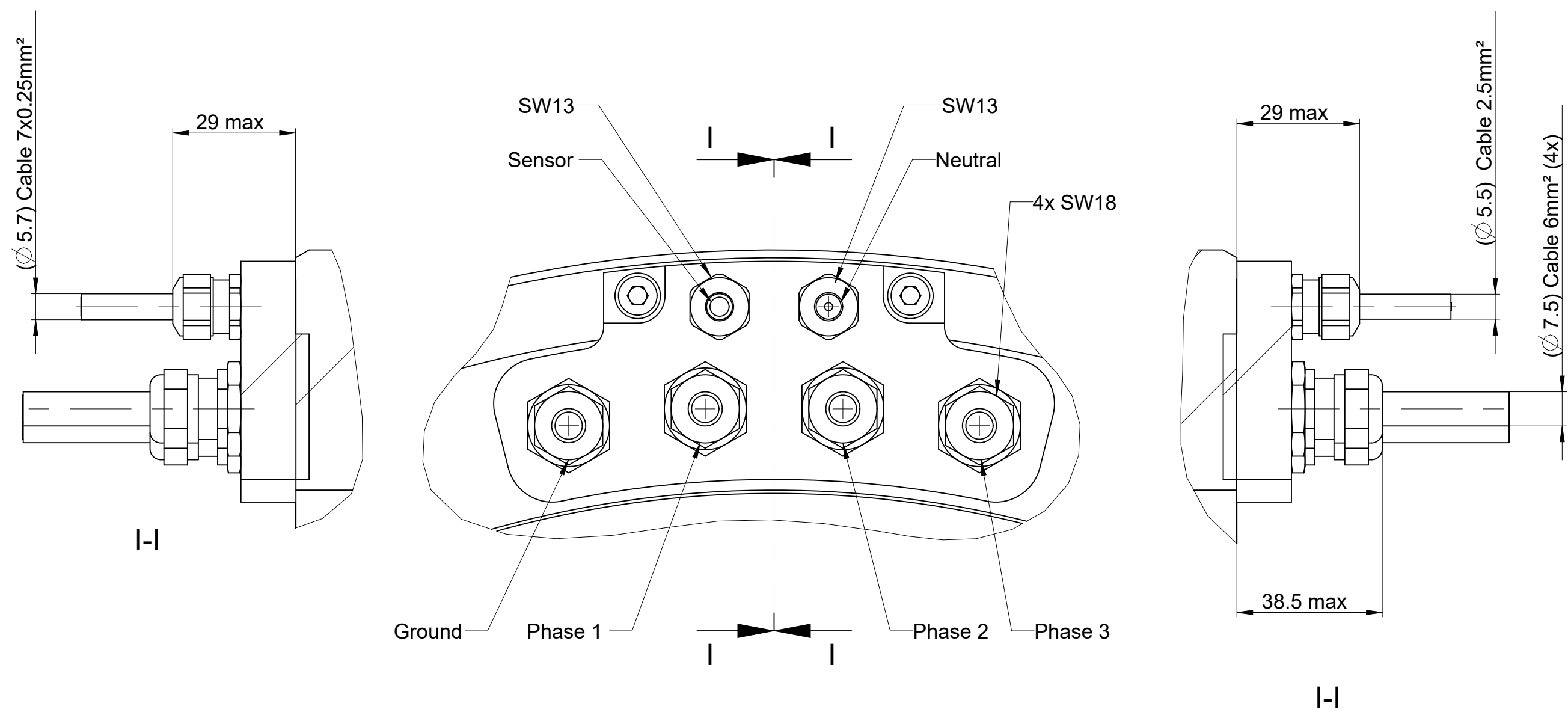

TMK0530-3VDN-U##

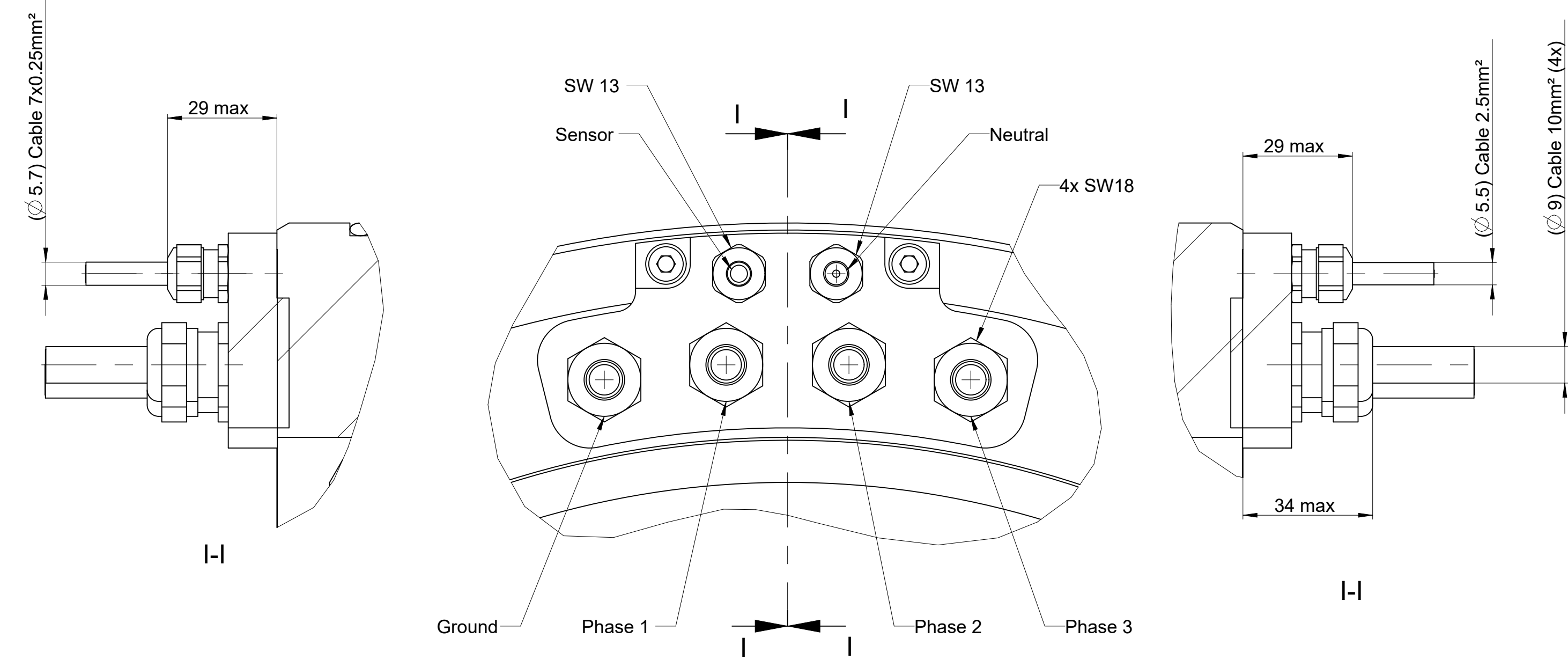

TMK0530-3VHN-U##

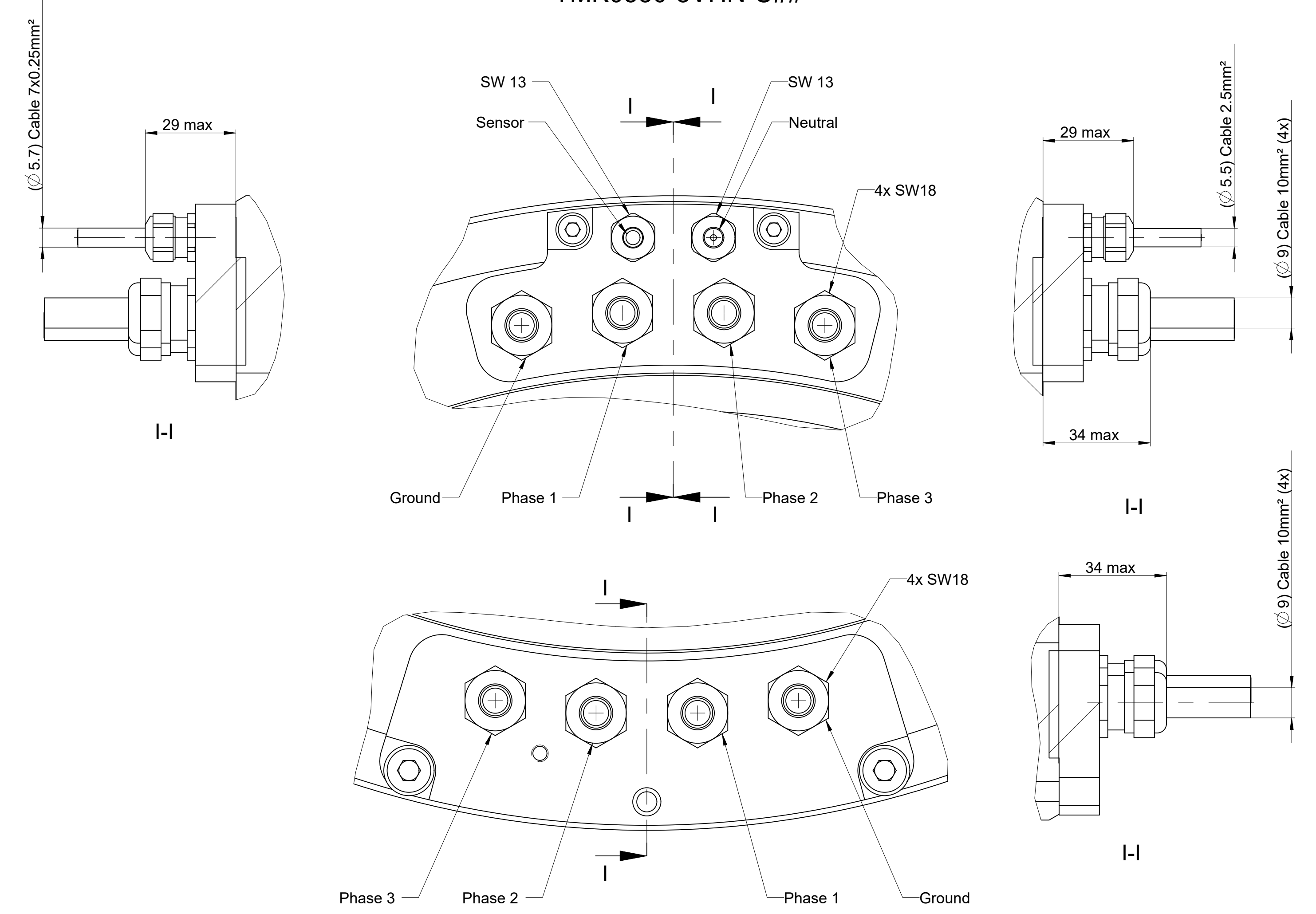

TMK0530-3UHN-U## and 3THN-U##

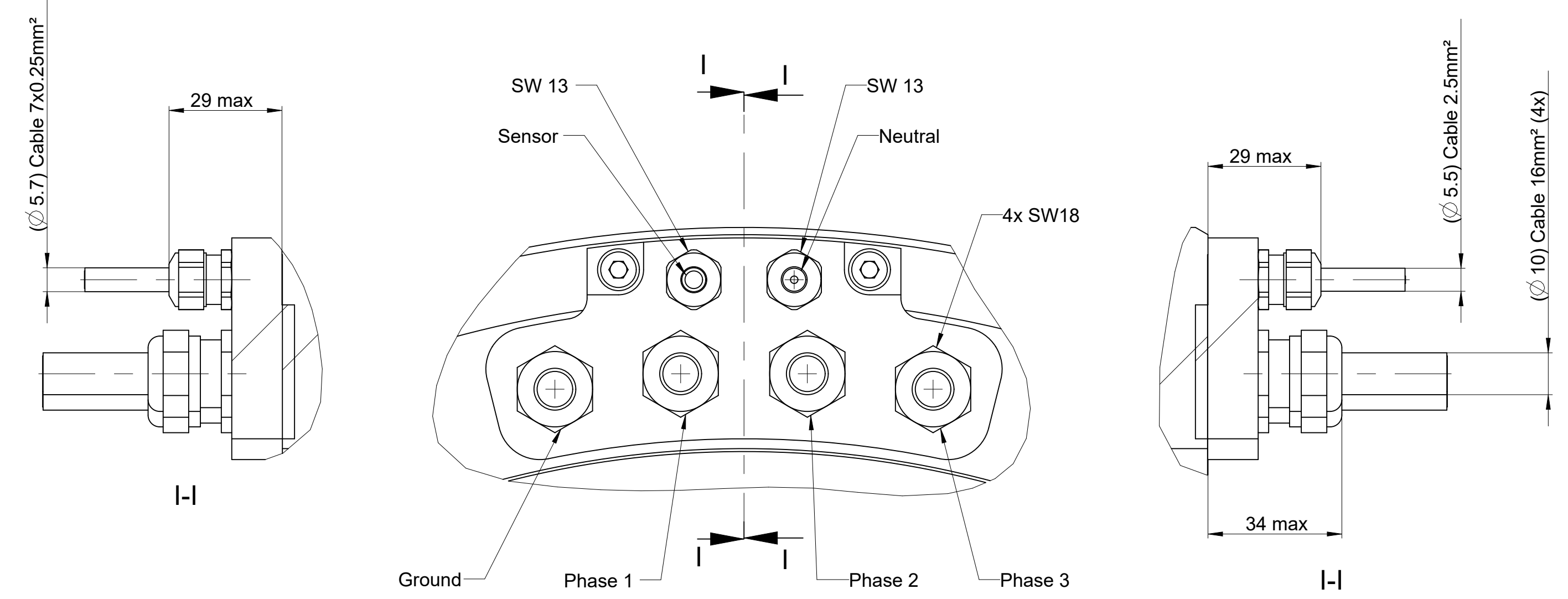

TMK0530-3TPN-U## and 3UPN-U##

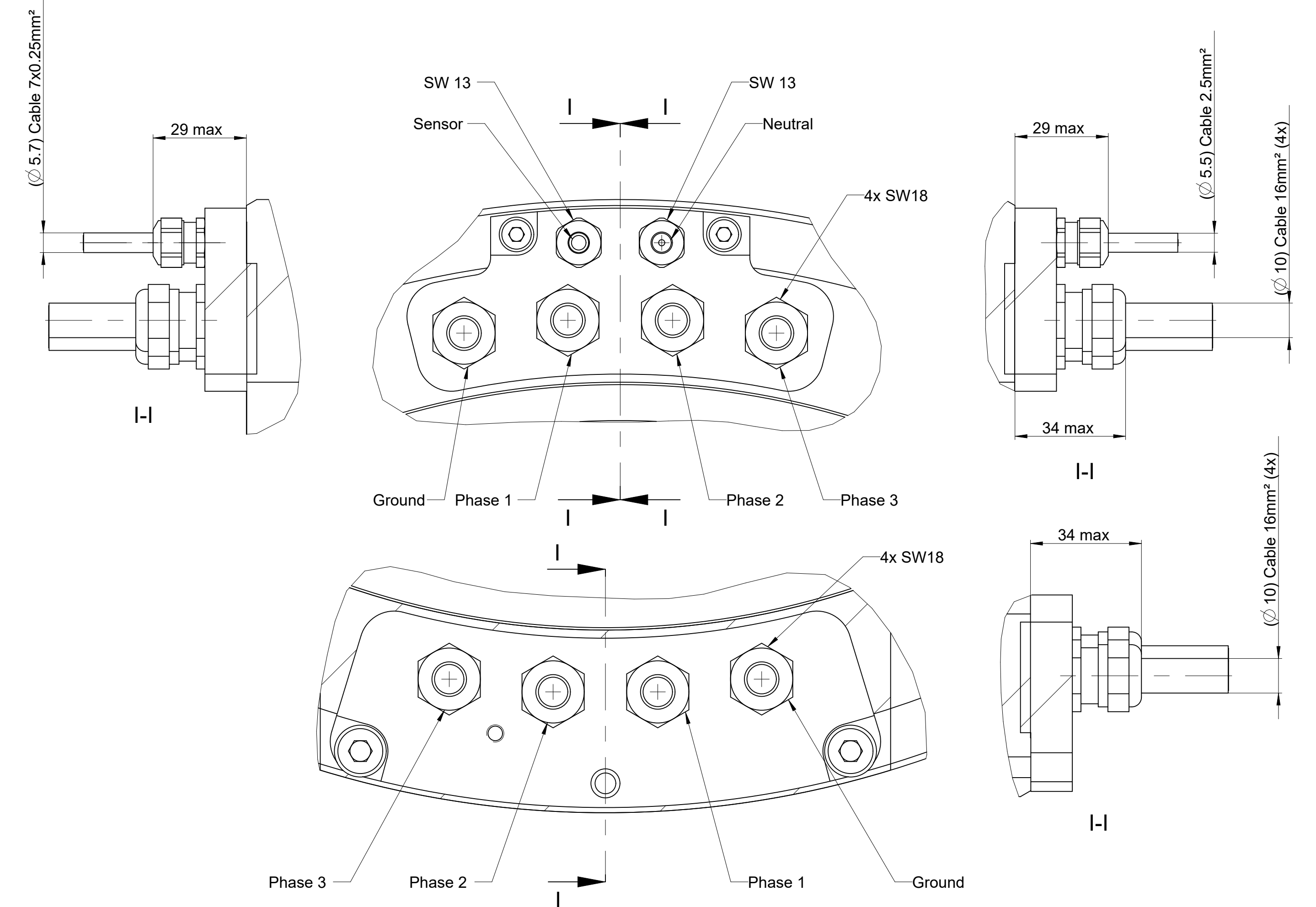

Text		ID number
Original drawing	Torque motor TMK0530 cables outputs (interface)	Change No. C115144-04
Scale 1:1	Format A0	Released: 18-09-2020
RoHS	Moteur coupleur fer TMK0530 sorties de câbles (interface)	Material: Matiere:
Dimensions in mm / Cotes en mm	Mating Dimensions / Cotes d'assemblage	Surface as per ISO 1302
Workpiece edges ISO 13715	General tolerances ISO 2768-mK	Etats de surface selon ISO 1302
±0.1	Tolerances generées ISO 2768-mK	Traitement de surface
±0.3	Tolerances as per ISO 8015 : 2011	Surface treatment
±0.3	Tolerances selon ISO 8015 : 2011	Traitement de surface
The reproduction, distribution and utilization of this document as well as the communication of its contents to others without express authorization is prohibited. Offenders will be held liable for the payment of damages. All rights reserved in the event of the grant of a patent, utility model or design. (ISO 15016)		
ETEL S.A. 2112 Môtiers SWITZERLAND		677923-05-A-02 Document number

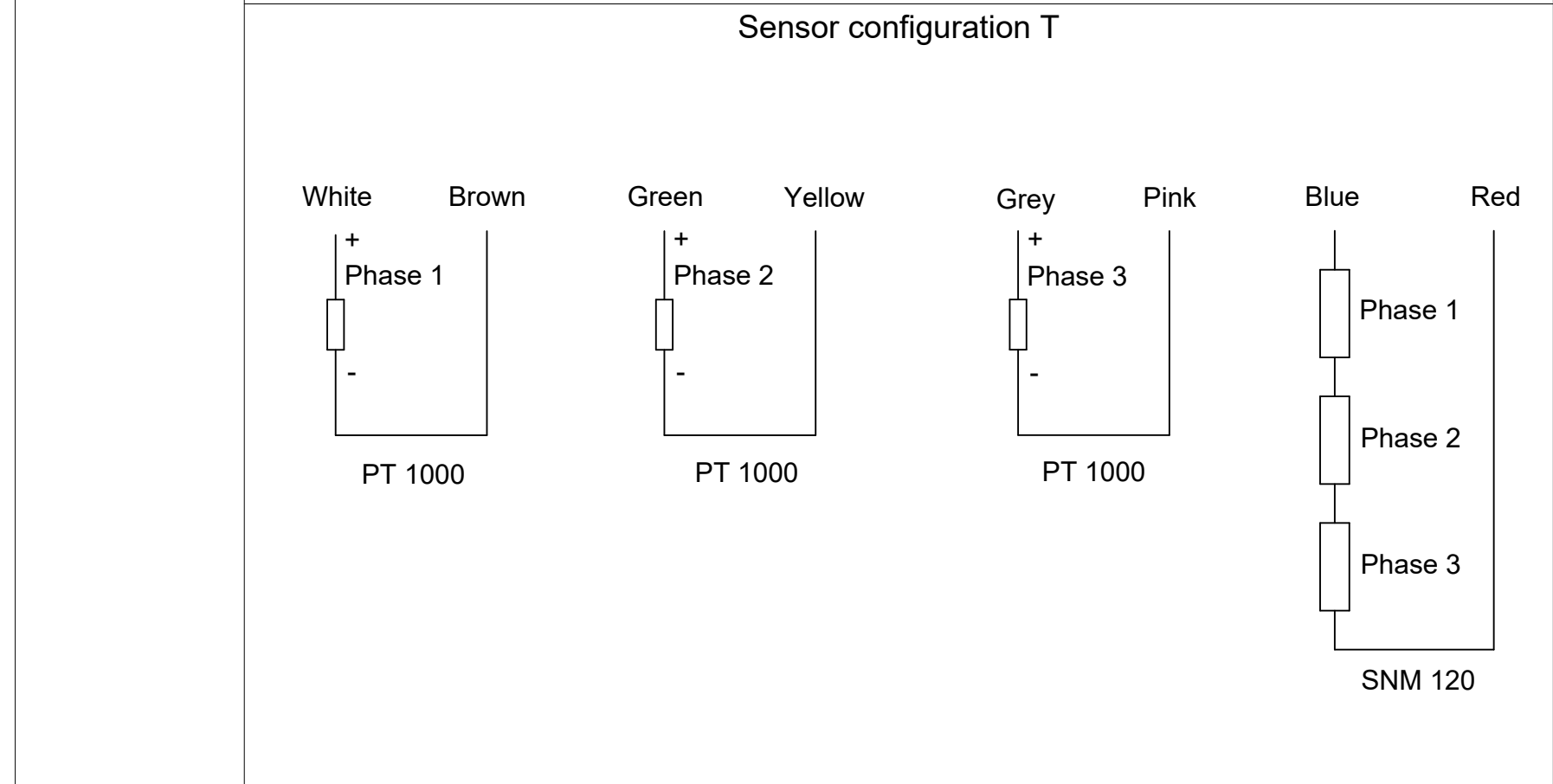
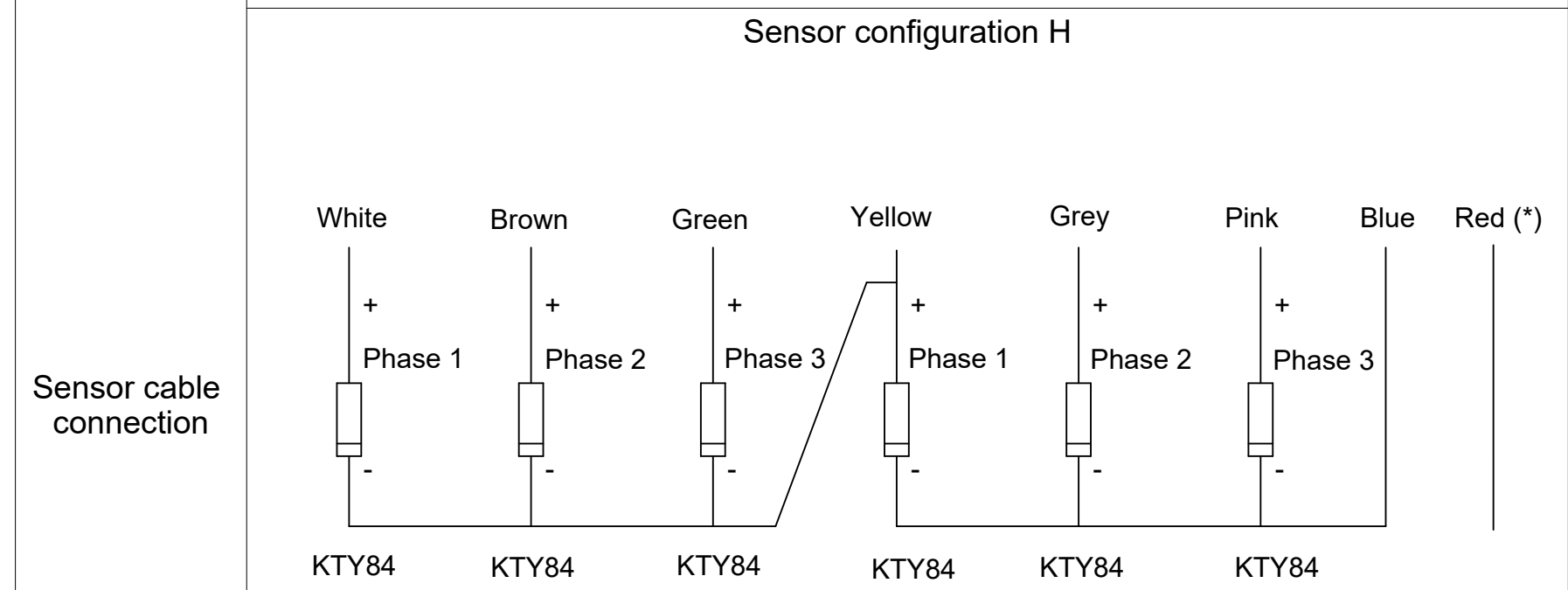
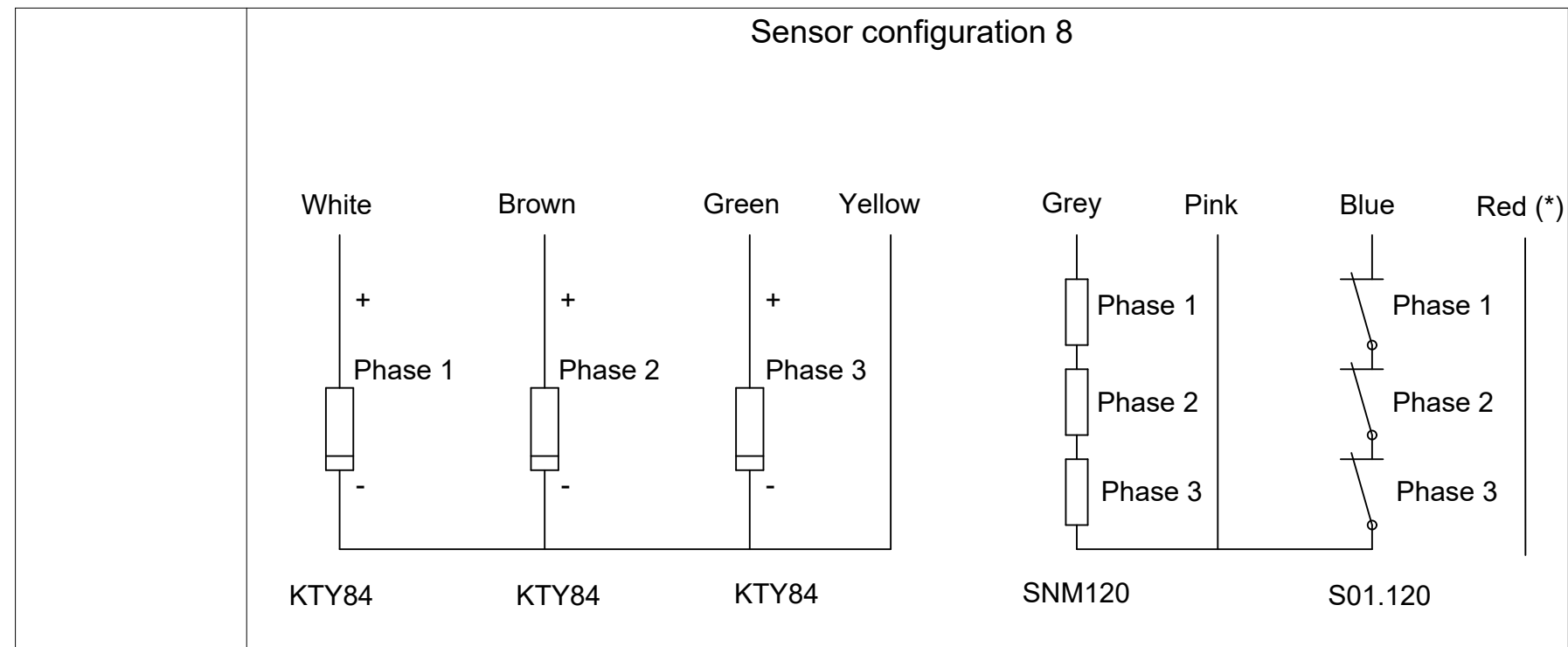

(\*): Red wire (if present) is not connected on the motor side and cutted flush on cable extremity.

### Power cable connection

Color and wire number	Function	Drawing
Black wire with number 1 or U	Phase 1 (PH1)	
Black wire with number 2 or V	Phase 2 (PH2)	
Black wire with number 3 or W	Phase 3 (PH3)	
Yellow and green wire	Ground (GND)	
Black wire with number Br1 or 5 or white cable	Neutral point wire (present only on some motor types)	
Black wire with number Br2 or 6 or black wire without label	None(**)	

(\*\*): This wire is automatically present when the neutral point wire (which is an option) is added in the motor as it is a 2 x 1 or 2 x 1.5 mm<sup>2</sup> cable.

### Wire section (mm<sup>2</sup>)

Characteristics	1 x 1.5	1 x 2.5	1 x 4	1 x 6	1 x 10	1 x 16	Sensor cable
Applicable motors	TMK0291 TMK0360 TMK0761 TMK0991	TMK0175 TMK0291 TMK0360 TMK0530	TMK0360	TMK0175 TMK0360 TMK0530	TMK0291 TMK0530 TMK0761	TMK0360 TMK0530 TMK0761 TMK0991	All TMK
Minimum bend radius for fixed cable	R = 5 X D	R = 4 X D	R = 4 X D	R = 4 X D	R = 4 X D	R = 4 X D	R = 6 X D
Minimum bend radius for moving cable	R = 10 x D	R = 7.5 X D	R = 7.5 X D	R = 7.5 X D	R = 7.5 X D	R = 7.5 X D	R = 12 X D

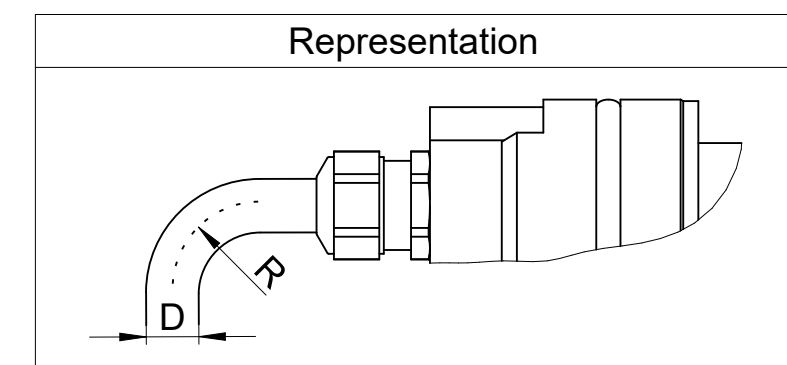

Text:		Original drawing Scale: 1:1 Format: A2		TMK sensor config. and cables prop. (interface)		ID number
RoHS		1:1 A2		TMK config. capteur et prop. câbles (interface)		Change No. C115144-05 Released: 18.09.2020
Workpiece edges ISO 13715 Arêtes de formes selon ISO 13715		General tolerances ISO 2768-mK Tolérances générales ISO 2768-mK		Surfaces as per ISO 1302 Etats de surface selon ISO 1302		Material: Matière:
Tolerances as per ISO 8015 : 2011 Tolérances selon ISO 8015 : 2011		Surface treatment: Traitement de surface:				
The reproduction, distribution and utilization of this document as well as the communication of its contents to others without express authorization is prohibited. Offenders will be held liable for the payment of damages. All rights reserved in the event of the grant of a patent, utility model or design. (ISO 16016)						
<b>ETEL</b>		ETEL S.A. 2112 Môtiers SWITZERLAND		Version/Revision/Sheet		Page
				1328572-00-A-01		1 of 1
				Document number		